

■DESCRIPTION

Designed to be mounted on the circuit board, the unit converts an input/output of unbalanced type into that of balanced type.

■SPECIFICATIONS

Impedance	600 Ω (±10%)
Frequency Response	200 - 10,000 Hz
Applicable Model	VM-2120, VM-2240, PP-025B

■APPEARANCE

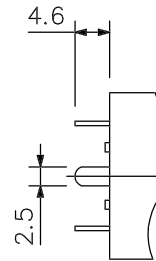
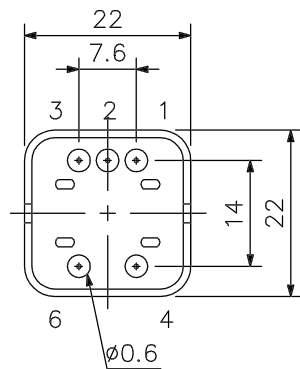
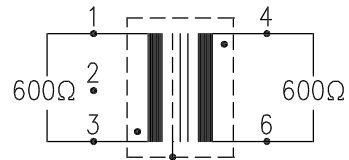
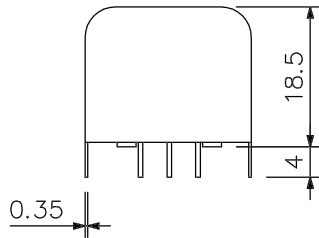

UNIT:mm SCALE:1/1